

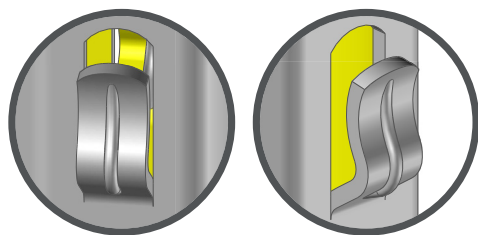

RAIL 35x30

Row Post
with hooks

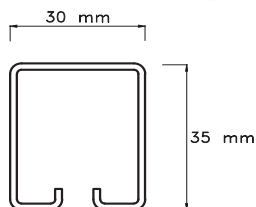

Hooks

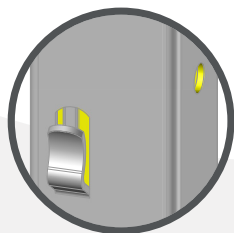

SLPA
INDUSTRIE & AGROFOURNITURES

[Retour vers le site](#)



Product Description

Row post with hook system and 100 mm spacing
Reinforced hooks for greater resistance
Galvanized coating

Benefits : RAIL 35 X 30, the most versatile

- Facilitates the installation and adaptation of the height of the trellising wires
- Shape of reinforced hooks studied to limit crushing
- Suitable for all types of vineyard locations
- Ideal to post replacement in existing vineyards, compact section and easy handling

Productivity

Density



Yield



Planting Height



Create your own product

Length	Min 1,40 m to Max 2,50 m
Material	S250GD or S250GD XCarb™ (low carbon steel)
Coating	Z275 (NF EN 10142) or ZAM (Zinc, Aluminium, Magnesium)
Thickness	Only 1,5 mm
Hooks Types	8,5 X 19 mm with support
Hooks Position	Face to face
Packaging	300 pieces per batch

Why choose SLPA® posts ?



Customization



Resistance



Weight



Life time



Productivity



Eco-Friendly



100% recyclable





RAIL 35x30

Row Post
with hooks

Accessories



Spreader

Adapted to the post.
The spreader allows you to keep the moving wires in a lower position when the vines are dormant. Save time during lifting.



Post cap

Adapted to the post. It protects the top of the post when pressing in.

Recommendations for use

When installing posts with a post driver, make sure to use the appropriate post cap.
In order to guarantee optimal support, the recommended installation depth is 1/3 length of the post.
For securing fixed wires, knock the hooks down with a hammer.
Recommended maximum interspacing : 5 m.
For high acidity soils, ZAM coating is recommended.

Notes

