

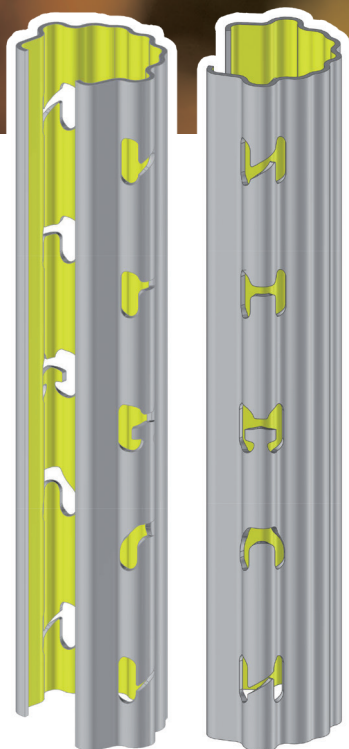

Row Post

with notch system



SLPA
INDUSTRIE & AGROFOURNITURES

[Retour vers le site](#)

Product Description

Row post with customizable notch system :

- **N**-inclined for fixed wires
- Straight in **H** or **M** for moving wires
- Inverted **U**-shaped for mechanical trellising

Galvanized coating

Additional drilling by request

Benefits : VULCAIN®, the most sturdy post

- Facilitates the installation and adaptation of the height of the trellising wires
- Wide and very resistant post suitable for all types of soil and vineyard locations
- Designed and tested for all types of mechanical work
- Maximum rigidity and stability (19 folds)

Productivity

Density



Yield



Planting Height

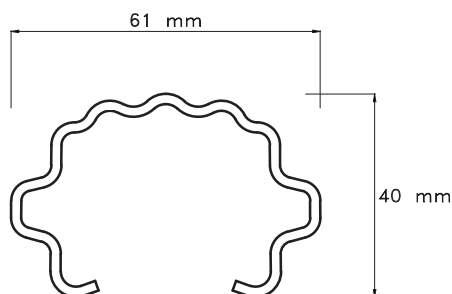

M

Inverted U

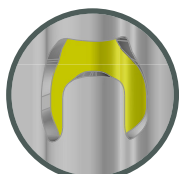
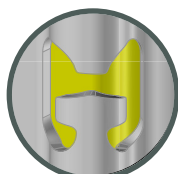

H

N

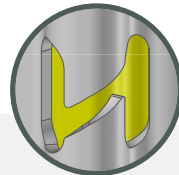
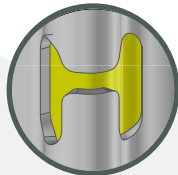

Create your own product

Length	Min. 1.20m to Max. 2.50m
Material	S250GD or S250GD XCarb™ (low carbon steel)
Coating	Z275 (NF EN 10142) or ZAM (Zinc, Aluminium, Magnesium)
Thickness	1,5 mm, 1,8 mm or 2 mm
Notch Types	Inclined « N » or straight « H » or « M » and/or inverted « U » Customizable spacing by request
Position of fixed wires notches	Face to face and/or offset (for better post resistance)
Packaging	300 pieces per batch

Why choose SLPA® posts ?



Customization



Resistance



Weight



Life time



Productivity



Eco-Friendly



100% recyclable



Vulcain®

VITICULTURE



Row Post
with notch system

Accessories



Plastic Clips

Removable hooks for synthetic moving wires.

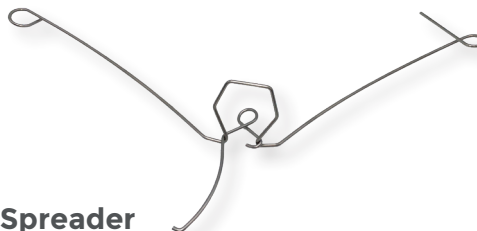

Spreader

Adapted to the post. The spreader allows you to keep the moving wires in a lower position when the vines are dormant. Save time during lifting.



Post cap

Adapted to the post. It protects the top of the post when pressing in.

Recommendations for use

When installing posts with a post driver, make sure to use the appropriate post cap. In order to guarantee optimal support, the recommended installation depth is 1/3 length of the post.

For row posts, the profile opening should always be facing the slope.

Recommended maximum interspacing : 5 m.

For high acidity soils, ZAM coating is recommended.

Notes

